

## TH NormBloc Maior ou Igual a 4cv Selo

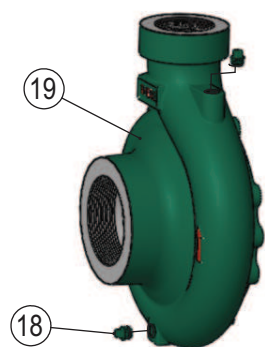
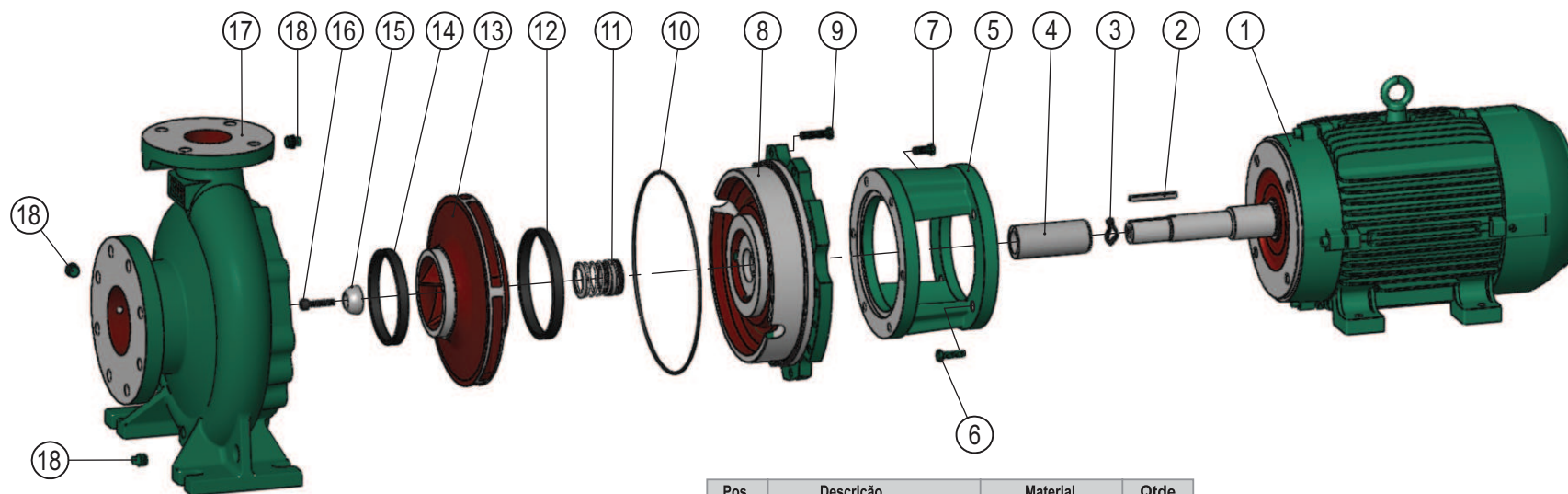

Pos.	Descrição	Material	Qtde
1	Motor elétrico IP-55	-	01
2	Chaveta Forma AA	SAE 1045	01
3	Anel o'ring	Borracha nitrílica	-
4	Bucha de Proteção eixo	AISI 304	01
5	Intermediário	ASTM A48 CL250	01
6	Parafuso sextavado	SAE 1020	04
7	Parafuso sextavado	SAE 1020	-
8	Tampa de pressão selo	ASTM A48 CL250	01
9	Parafuso sextavado	SAE 1020	-
10	Anel o'ring da tampa	Borracha Nitrílica	01
11	Selo mecânico T21	-	01
12	Anel de desgaste do rotor	ASTM A536 65-45-12	01
13	Rotor	ASTM A48 CL250	01
14	Anel de desgaste carcaça	ASTM A536 65-45-12	01
15	Semi-esfera eixo TH	AISI420/SAE1045	01
16	Parafuso allen	SAE 1020	01
17	Carcaça flangeada	ASTM A48 CL250	01
18	Bujão	SAE 1020	03
19	Carcaça rosca (Opcional)	ASTM A48 CL250	01

## Relação de Peças TH-125/200 Monobloco Selo Flange

	Código	Descrição	15,0 à 25,0 CV Qtd	30,0 à 60,0 CV Qtd
<b>MOTOR</b>	- - -	MOTOR BLINDADO IP-55	1	1
<b>INTERMED.</b>	1127.04.02689	INTERMEDIARIO TH-50 10,0 A 25,0 CV	1	-
	1127.04.02690	INTERMEDIARIO TH-50 30,0 CV	-	1
	1127.04.01104	PARAF.SEXT.UNC 1/2 x 1 1/4 RI	4	-
	1127.04.00722	PARAF.SEXT.UNC 5/8 x 1 1/4 RI	-	4
<b>TAMPA PRES.</b>	1127.04.10160	ANEL O'RING 221,92 x 2,62MM BUNA-N	1	1
	1127.04.03312	TAMPA PRES.TH-125-150(200) B-SELO 1.3/4	1	1
<b>SELO</b>	1127.04.10069	ANEL O'RING DIAM.34,65x1,78MM	1	1
	1127.04.02903	BUCHA PROTECAO DO EIXO TH-100/315 MONOBL. SELO INOX 304	1	1
	1127.04.00229	SELO MEC.1 3/4" T21 BUNA COD.665191	1	1
<b>ROTOR</b>	1127.04.02194	ANEL DESG.TH-80/400R - TH-100/250R/400R - TH-125/200R.S/250R.S/315S/400R.S	1	1
	1127.04.03402	ROTOR TH-125/200 218X31.75 BLOC	1	1
<b>SEMI-ESFERA</b>	1127.04.03077	PARAF. ALLEN 1/2" X 1.1/2" C/CAB. UNC	1	1
	1127.04.03080	SEMI-ESFERA Ø38	1	1
<b>CARCACA</b>	1127.04.02194	ANEL DESG.TH-80/400R - TH-100/250R/400R - TH-125/200R.S/250R.S/315S/400R.S	1	1
	1127.04.00775	BUJAO 1/2" BSP PRETA	3	3
	1127.04.02437	CARCACA TH-125/200	1	1
	1127.04.00329	PARAF.SEXT.BSW 1/2 x 1 1/2 RI	8	8

	Kit Contra Flange	Bocal	Qtde
1127.04.00658	CONTRA FLANGE DN150 125LB PN16 BSP	SUC - 6"	1
1127.04.05551	CONTRA FLANGE ANSI DN125 125LB BSP	REC - 5"	1
1127.04.04309	PARAF.SEXT.UNC 3/4 x 3 RP	SUC/REC	16
1127.04.00636	PORCA SEXT.UNC 3/4"	SUC/REC	16
1127.04.07887	JUNTA BORRACHA P/C.FLANGE ANSI DN125 125LB BSP (5551)	SUC	1
1127.04.07900	JUNTA BORRACHA P/C.FLANGE DN150 125LB PN16 BSP (0658)	REC	1

**OBS:** Bomba com motor de 25,0 cv 4 Polos utiliza-se as peças de 30,0 cv