

CURVA DE PERFORMANCE

60Hz

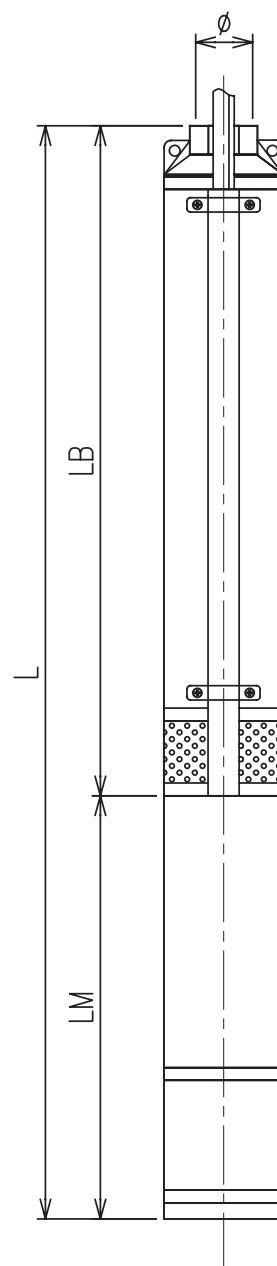
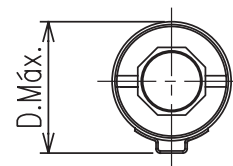
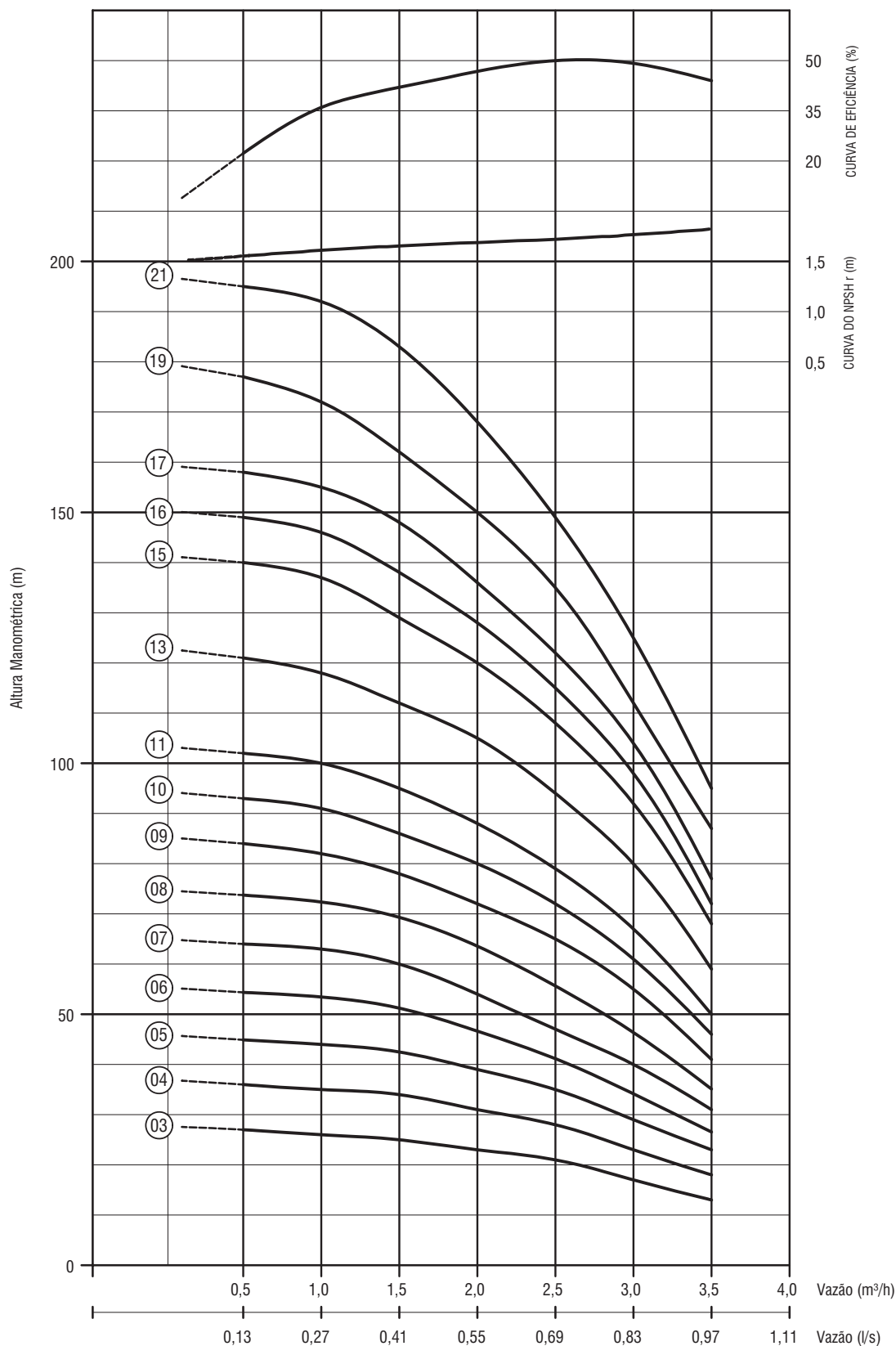

**CURVA DE PERFORMANCE**

**60Hz**

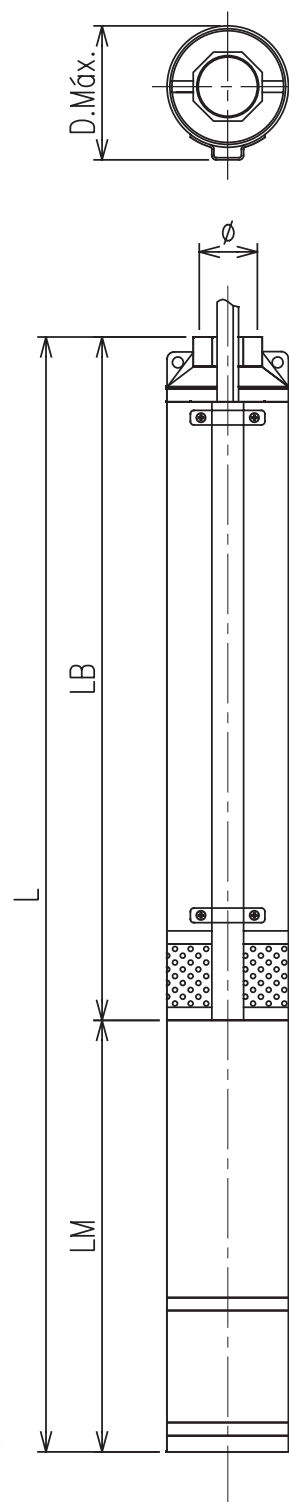
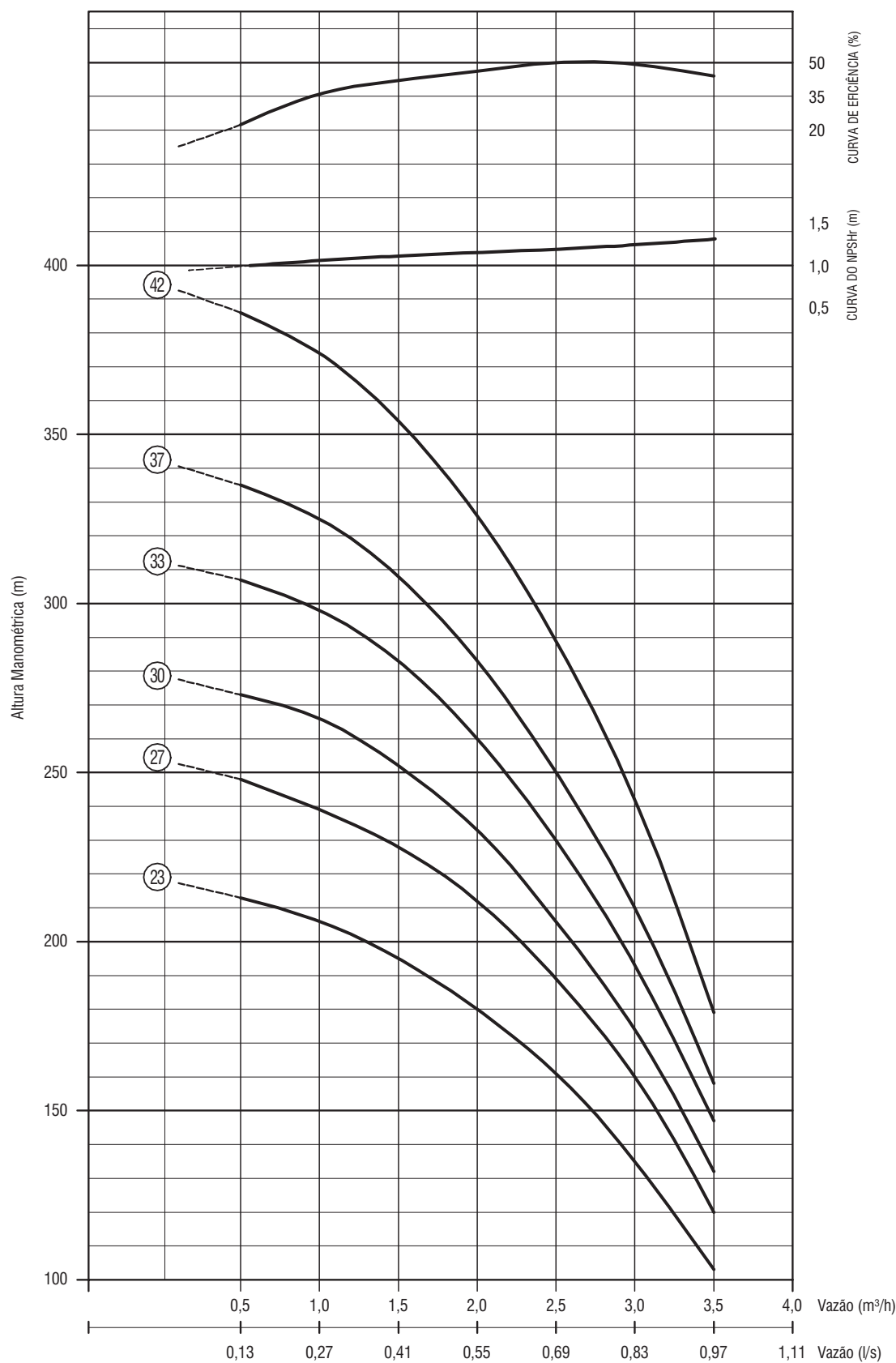

## TABELA PARA SELEÇÃO DE EQUIPAMENTOS

BOMBA	N° EST.	MOTOR	POTENCIA		VAZÃO E ALTURA MANOMÉTRICA										LB	TRIF												TRIF				MONO				MONO				MONO				D max (mm)	Q max BSH																																																																																																																																																																																																																																																																																																																																																																																																																																																																																																																																																																																																																																																																																																																																																																																																																																																																																																																																															
			HP	kW	0,0	0,5	1,0	1,5	2,0	2,5	3,0	3,5	4,0	5,0		6,0	7,0	8,0	9,0	10,0	11,0	12,0	13,0	14,0	15,0	16,0	17,0	18,0	19,0	20,0	21,0	22,0	23,0	24,0	25,0	26,0	27,0	28,0	29,0	30,0	31,0	32,0	33,0			34,0	35,0	36,0	37,0	38,0	39,0	40,0	41,0	42,0	43,0	44,0	45,0	46,0	47,0	48,0	49,0	50,0	51,0	52,0	53,0	54,0	55,0	56,0	57,0	58,0	59,0	60,0	61,0	62,0	63,0	64,0	65,0	66,0	67,0	68,0	69,0	70,0	71,0	72,0	73,0	74,0	75,0	76,0	77,0	78,0	79,0	80,0	81,0	82,0	83,0	84,0	85,0	86,0	87,0	88,0	89,0	90,0	91,0	92,0	93,0	94,0	95,0	96,0	97,0	98,0	99,0	100,0	101,0	102,0	103,0	104,0	105,0	106,0	107,0	108,0	109,0	110,0	111,0	112,0	113,0	114,0	115,0	116,0	117,0	118,0	119,0	120,0	121,0	122,0	123,0	124,0	125,0	126,0	127,0	128,0	129,0	130,0	131,0	132,0	133,0	134,0	135,0	136,0	137,0	138,0	139,0	140,0	141,0	142,0	143,0	144,0	145,0	146,0	147,0	148,0	149,0	150,0	151,0	152,0	153,0	154,0	155,0	156,0	157,0	158,0	159,0	160,0	161,0	162,0	163,0	164,0	165,0	166,0	167,0	168,0	169,0	170,0	171,0	172,0	173,0	174,0	175,0	176,0	177,0	178,0	179,0	180,0	181,0	182,0	183,0	184,0	185,0	186,0	187,0	188,0	189,0	190,0	191,0	192,0	193,0	194,0	195,0	196,0	197,0	198,0	199,0	200,0	201,0	202,0	203,0	204,0	205,0	206,0	207,0	208,0	209,0	210,0	211,0	212,0	213,0	214,0	215,0	216,0	217,0	218,0	219,0	220,0	221,0	222,0	223,0	224,0	225,0	226,0	227,0	228,0	229,0	230,0	231,0	232,0	233,0	234,0	235,0	236,0	237,0	238,0	239,0	240,0	241,0	242,0	243,0	244,0	245,0	246,0	247,0	248,0	249,0	250,0	251,0	252,0	253,0	254,0	255,0	256,0	257,0	258,0	259,0	260,0	261,0	262,0	263,0	264,0	265,0	266,0	267,0	268,0	269,0	270,0	271,0	272,0	273,0	274,0	275,0	276,0	277,0	278,0	279,0	280,0	281,0	282,0	283,0	284,0	285,0	286,0	287,0	288,0	289,0	290,0	291,0	292,0	293,0	294,0	295,0	296,0	297,0	298,0	299,0	300,0	301,0	302,0	303,0	304,0	305,0	306,0	307,0	308,0	309,0	310,0	311,0	312,0	313,0	314,0	315,0	316,0	317,0	318,0	319,0	320,0	321,0	322,0	323,0	324,0	325,0	326,0	327,0	328,0	329,0	330,0	331,0	332,0	333,0	334,0	335,0	336,0	337,0	338,0	339,0	340,0	341,0	342,0	343,0	344,0	345,0	346,0	347,0	348,0	349,0	350,0	351,0	352,0	353,0	354,0	355,0	356,0	357,0	358,0	359,0	360,0	361,0	362,0	363,0	364,0	365,0	366,0	367,0	368,0	369,0	370,0	371,0	372,0	373,0	374,0	375,0	376,0	377,0	378,0	379,0	380,0	381,0	382,0	383,0	384,0	385,0	386,0	387,0	388,0	389,0	390,0	391,0	392,0	393,0	394,0	395,0	396,0	397,0	398,0	399,0	400,0	401,0	402,0	403,0	404,0	405,0	406,0	407,0	408,0	409,0	410,0	411,0	412,0	413,0	414,0	415,0	416,0	417,0	418,0	419,0	420,0	421,0	422,0	423,0	424,0	425,0	426,0	427,0	428,0	429,0	430,0	431,0	432,0	433,0	434,0	435,0	436,0	437,0	438,0	439,0	440,0	441,0	442,0	443,0	444,0	445,0	446,0	447,0	448,0	449,0	450,0	451,0	452,0	453,0	454,0	455,0	456,0	457,0	458,0	459,0	460,0	461,0	462,0	463,0	464,0	465,0	466,0	467,0	468,0	469,0	470,0	471,0	472,0	473,0	474,0	475,0	476,0	477,0	478,0	479,0	480,0	481,0	482,0	483,0	484,0	485,0	486,0	487,0	488,0	489,0	490,0	491,0	492,0	493,0	494,0	495,0	496,0	497,0	498,0	499,0	500,0	501,0	502,0	503,0	504,0	505,0	506,0	507,0	508,0	509,0	510,0	511,0	512,0	513,0	514,0	515,0	516,0	517,0	518,0	519,0	520,0	521,0	522,0	523,0	524,0	525,0	526,0	527,0	528,0	529,0	530,0	531,0	532,0	533,0	534,0	535,0	536,0	537,0	538,0	539,0	540,0	541,0	542,0	543,0	544,0	545,0	546,0	547,0	548,0	549,0	550,0	551,0	552,0	553,0	554,0	555,0	556,0	557,0	558,0	559,0	560,0	561,0	562,0	563,0	564,0	565,0	566,0	567,0	568,0	569,0	570,0	571,0	572,0	573,0	574,0	575,0	576,0	577,0	578,0	579,0	580,0	581,0	582,0	583,0	584,0	585,0	586,0	587,0	588,0	589,0	590,0	591,0	592,0	593,0	594,0	595,0	596,0	597,0	598,0	599,0	600,0	601,0	602,0	603,0	604,0	605,0	606,0	607,0	608,0	609,0	610,0	611,0	612,0	613,0	614,0	615,0	616,0	617,0	618,0	619,0	620,0	621,0	622,0	623,0	624,0	625,0	626,0	627,0	628,0	629,0	630,0	631,0	632,0	633,0	634,0	635,0	636,0	637,0	638,0	639,0	640,0	641,0	642,0	643,0	644,0	645,0	646,0	647,0	648,0	649,0	650,0	651,0	652,0	653,0	654,0	655,0	656,0	657,0	658,0	659,0	660,0	661,0	662,0	663,0	664,0	665,0	666,0	667,0	668,0	669,0	670,0	671,0	672,0	673,0	674,0	675,0	676,0	677,0	678,0	679,0	680,0	681,0	682,0	683,0	684,0	685,0	686,0	687,0	688,0	689,0	690,0	691,0	692,0	693,0	694,0	695,0	696,0	697,0	698,0	699,0	700,0	701,0	702,0	703,0	704,0	705,0	706,0	707,0	708,0	709,0	710,0	711,0	712,0	713,0	714,0	715,0	716,0	717,0	718,0	719,0	720,0	721,0	722,0	723,0	724,0	725,0	726,0	727,0	728,0	729,0	730,0	731,0	732,0	733,0	734,0	735,0	736,0	737,0	738,0	739,0	740,0	741,0	742,0	743,0	744,0	745,0	746,0	747,0	748,0	749,0	750,0	751,0	752,0	753,0	754,0	755,0	756,0	757,0	758,0	759,0	760,0	761,0	762,0	763,0	764,0	765,0	766,0	767,0	768,0	769,0	770,0	771,0	772,0	773,0	774,0	775,0	776,0	777,0	778,0	779,0	780,0	781,0	782,0	783,0	784,0	785,0	786,0	787,0	788,0	789,0	790,0	791,0	792,0	793,0	794,0	795,0	796,0	797,0	798,0	799,0	800,0	801,0	802,0	803,0	804,0	805,0	806,0	807,0	808,0	809,0	810,0	811,0	812,0	813,0	814,0	815,0	816,0	817,0	818,0	819,0	820,0	821,0	822,0	823,0	824,0	825,0	826,0	827,0	828,0	829,0	830,0	831,0	832,0	833,0	834,0	835,0	836,0	837,0	838,0	839,0	840,0	841,0	842,0	843,0	844,0	845,0	846,0	847,0	848,0	849,0	850,0	851,0	852,0	853,0	854,0	855,0	856,0	857,0	858,0	859,0	860,0	861,0	862,0	863,0	864,0	865,0	866,0	867,0	868,0	869,0	870,0	871,0	872,0	873,0	874,0	875,0	876,0	877,0	878,0	879,0	880,0	881,0	882,0	883,0	884,0	885,0	886,0	887,0	888,0	889,0	890,0	891,0	892,0	893,0	894,0	895,0	896,0	897,0	898,0	899,0	900,0	901,0	902,0	903,0	904,0	905,0	906,0	907,0	908,0	909,0	910,0	911,0	912,0	913,0	914,0	915,0	916,0	917,0	918,0	919,0	920,0	921,0	922,0	923,0	924,0	925,0	926,0	927,0	928,0	929,0	930,0	931,0	932,0	933,0	934,0	935,0	936,0	937,0	938,0	939,0	940,0	941,0	942,0	943,0	



MOTOBOMBAS SUBMERSAS  
PARA POÇOS DE MÍN. 4”

MODELO  
4BPS3 i/f

TABELA PARA SELEÇÃO DE EQUIPAMENTOS

BOMBA MODELO	N° EST.	MOTOR MODELO	POTÊNCIA		VAZÃO E ALTURA MANOMÉTRICA										LB	TRIF			TRIF			TRIF			MONO 115V			MONO 220V			MONO 254V			MONO 440V			Ø max. (mm)	Ø POL. ESP.
			HP	KW	0.0	0.5	1.0	1.5	2.0	2.5	3.0	3.5	㊚/㊚	LM		L	kg	LM	L	kg	LM	L	kg	LM	L	kg	LM	L	kg	LM	L	kg						
4BPS3-17	17	M4P2	2,00	1,49										505	508	1013	24,30	508	1013	24,30	563	1068	26,90	563	1068	26,90	563	1068	26,90	563	1068	26,90						
		OM4A	2,00	1,49	162,0	158,0	155,0	148,0	136,0	122,0	104,0	77,0	m	505	503	1008	17,20	503	1008	17,36				490	985	19,51	490	985	19,51	490	985	19,51						
		4WP	2,00	1,49										505	340	845	17,70	340	845	17,70				375	880	20,30	375	880	20,30	375	880	20,30						
														544	613	1157	29,30	613	1157	29,30	643	1187	31,10				613	1157	29,30	613	1157	29,30						
4BPS3-19	19	OM4A	2,00	1,49	180,0	177,0	172,0	162,0	150,0	135,0	112,0	87,0	m	544	503	1047	17,60	503	1047	17,76				490	1034	19,91	490	1034	19,91	490	1034	19,91						
		4WP	2,00	1,49										544	340	884	18,10	340	884	18,10				375	919	20,70	375	919	20,70	375	919	20,70						
														583	613	1196	29,80	613	1196	29,80	643	1226	31,60				613	1196	29,80	613	1196	29,80						
														583	503	1086	18,10	503	1086	18,26				490	1073	20,41	490	1073	20,41	490	1073	20,41						
4BPS3-23	23	4WP	2,00	1,49										583	340	923	18,60	340	923	18,60				375	958	21,20	375	958	21,20	375	958	21,20						
														622	613	1235	30,20	643	1265	32,00	643	1265	32,00				613	1235	30,20	613	1235	30,20	643	1265	32,00			
		OM4A	3,00	2,24	217,0	213,0	206,0	195,0	180,0	161,0	135,0	103,0	m	622	558	1180	21,34	558	1180	21,20				550	1172	23,68	550	1172	23,68	550	1172	23,68						
		4WP	3,00	2,24										622	375	997	21,80	375	997	21,80				430	1052	24,00	430	1052	24,00	430	1052	24,00						
4BPS3-27	27	M4P7	3,50	2,61										733	730	1463	35,80	730	1463	35,80	730	1463	35,80				730	1463	35,80	730	1463	35,80	790	1523	36,80			
		OM4A	3,00	2,24	250,0	246,0	239,0	228,0	212,0	189,0	160,0	120,0	m	733	558	1291	22,54	558	1291	22,40				550	1283	24,88	550	1283	24,88	550	1283	24,88						
		4WP	3,00	2,24										733	375	1108	23,00	375	1108	23,00				430	1163	25,20	430	1163	25,20	430	1163	25,20						
														792	730	1522	36,50	730	1522	36,50	730	1522	36,50				730	1522	36,50	730	1522	36,50	790	1582	38,50			
4BPS3-30	30	OM4A	4,00	2,98										792	792	1620	41,2	620	1412	26,81																		
		4WP	5,00	3,73	279,0	273,0	266,0	252,0	233,0	206,0	174,0	132,0	m	792	620	1412	26,81	620	1412	26,81																		
		4WP	5,00	3,73										792																								
		4WP	5,50	4,1										792	555	1347	32,90	555	1347	32,90																		
4BPS3-33	33	M4P7	4,50	3,36										850	790	1640	40,20	790	1640	40,20	790	1640	40,20				790	1640	40,20	790	1640	40,20						
		OM4A	4,00	2,98										850	620	1470	27,51	620	1470	27,51																		
		4WP	5,00	3,73	312,0	307,0	298,0	283,0	260,0	230,0	193,0	147,0	m	850																								
		4WP	5,50	4,1										850	555	1405	33,60	555	1405	33,60																		
4BPS3-37	37	M4P7	5,00	3,73										928	790	1718	41,10	790	1718	41,10	790	1718	41,10				790	1718	41,10	790	1718	41,10						
		OM4A	5,50	4,1										928	675	1603	30,92	675	1603	31,01																		
		4WP	5,00	3,73	339,0	335,0	325,0	308,0	283,0	250,0	210,0	158,0	m	928																								
		4WP	5,50	4,1										928	555	1483	34,50	555	1483	34,50																		
4BPS3-42	42	M4P7	5,50	4,1										1026	790	1816	42,50	790	1816	42,50	790	1816	42,50															
		OM4A	5,50	4,1										1026	675	1701	32,32	675	1701	32,41																		
		4WP	5,00	3,73	390,0	386,0	374,0	354,0	326,0	289,0	242,0	179,0	m	1026																								
		4WP	5,50	4,1										1026	555	1581	35,90	555	1581	35,90																		