

CURVA DE PERFORMANCE

60Hz

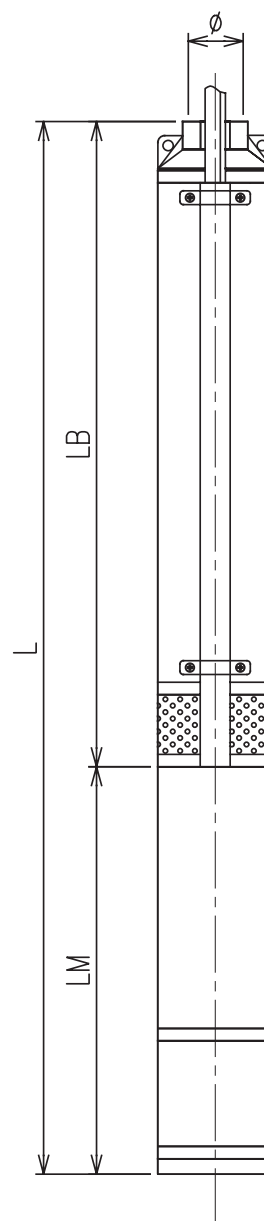

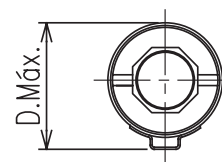
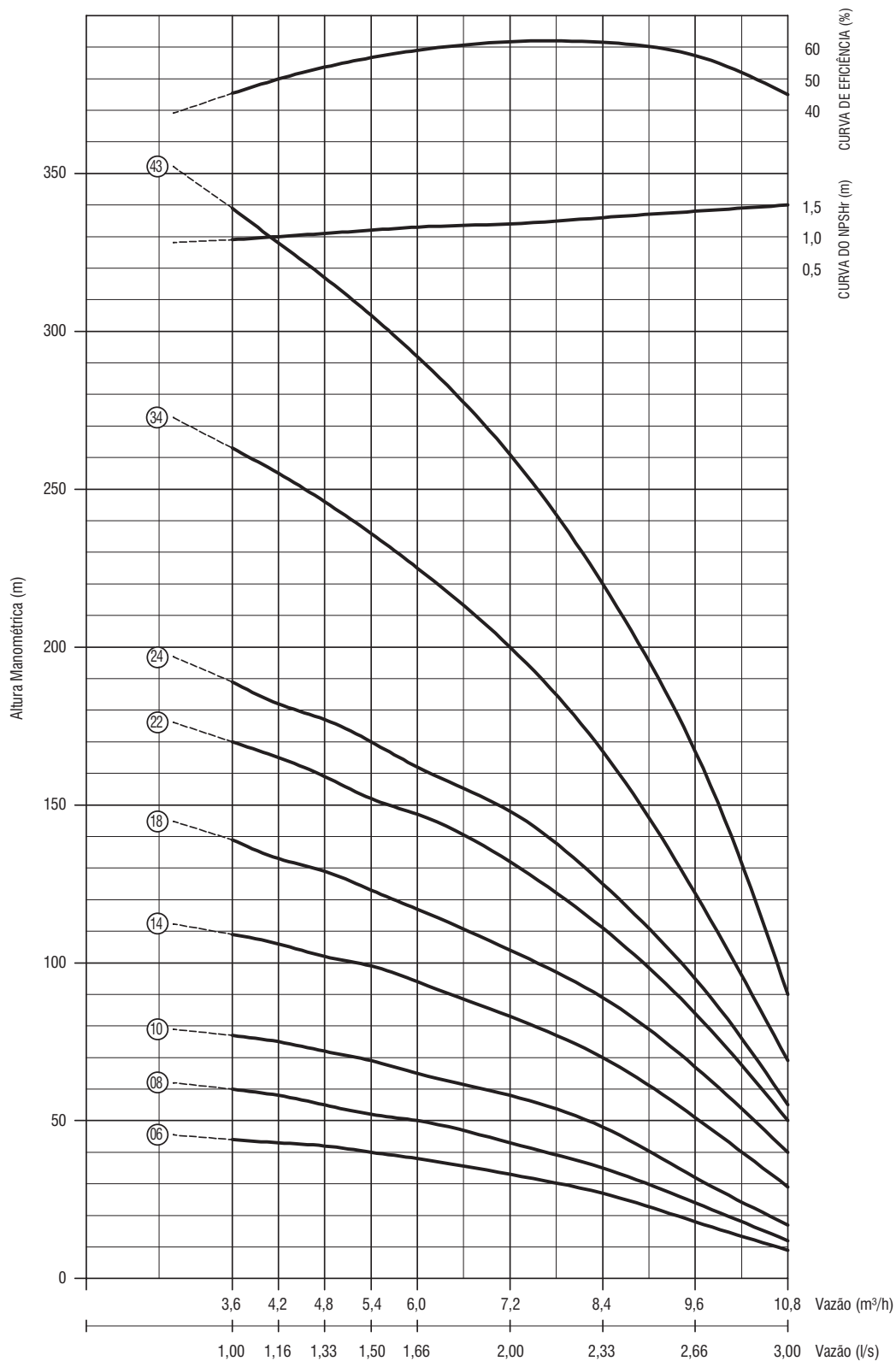

MOTOBOMBAS SUBMERSAS
PARA POÇOS DE MÍN. 4”

MODELO
4BPS9i

TABELA PARA SELEÇÃO DE EQUIPAMENTOS

BOMBA MODELO	N° EST.	MOTOR MODELO	POTÊNCIA		VAZÃO E ALTURA MANOMÉTRICA												LB		TRIF 220V			TRIF 380V			TRIF 440V			MONO 220V			MONO 254V			MONO 440V			Ø POL BSP
			HP	KW	0,0	3,6	4,2	4,8	5,4	6,0	7,2	8,4	9,6	10,8	m³/h	LM	L	kg	LM	L	kg	LM	L	kg	LM	L	kg	LM	L	kg	LM	L	kg				
4BPS9-06	06	M4P2	1,50	1,12											359	488	827	19,80	468	827	19,80	468	827	19,80	563	922	24,00	563	922	24,00	563	922	24,00	563	922	24,00	
		OM4A	1,00	0,75	52,0	44,0	43,0	42,0	40,0	38,0	33,0	27,0	18,0	9,0	m	359	458	817	12,60	458	817	12,96				410	769	12,81	410	769	12,81						
		OM4A 2F	1,00	0,75											359											468	827	13,34									
		4WP	1,00	0,75											359	265	624	11,70	265	624	11,70				295	654	14,00	295	654	14,00							
4BPS9-08	08	M4P2	2,00	1,49											421	508	929	22,00	508	929	22,00	508	929	22,00	563	984	24,60	563	984	24,60	563	984	24,60	563	984	24,60	
		OM4A	1,50	1,12	70,0	60,0	58,0	55,0	52,0	50,0	43,0	35,0	24,0	12,0	m	421	493	914	14,63	493	914	14,88				445	866	15,37	445	866	15,37						
		OM4A 2F	1,50	1,12											421											503	924	15,62									
		4WP	1,50	1,12											421	295	716	14,90	295	716	14,90				340	761	15,20	340	761	15,20							
4BPS9-10	10	M4P2	2,50	1,86											483	613	1096	27,20	613	1096	27,20	613	1096	27,20	613	1096	27,20	613	1096	27,20	613	1096	27,20	613	1096	27,20	
		OM4A	2,00	1,49	91,0	77,0	75,0	72,0	69,0	65,0	58,0	48,0	32,0	17,0	m	483	503	986	15,50	503	986	15,66				490	973	17,81	490	973	17,81						
		4WP	2,00	1,49											483	340	823	16,00	340	823	16,00				375	858	18,60	375	858	18,60							
		M4P7	3,50	2,61											607	730	1337	32,70	730	1337	32,70	730	1337	32,70	730	1337	32,70	730	1337	32,70	730	1337	32,70	730	1337	32,70	
4BPS9-14	14	OM4A	3,00	2,24	128,0	109,0	106,0	102,0	99,0	94,0	83,0	70,0	51,0	29,0	m	607	558	1165	19,44	558	1165	19,30				550	1157	21,78	550	1157	21,78						
		4WP	3,00	2,24											607	375	982	19,90	375	982	19,90				430	1037	22,10	430	1037	22,10							
		M4P7	4,50	3,36											731	790	1521	36,90	790	1521	36,90	790	1521	36,90	790	1521	36,90	790	1521	36,90	790	1521	36,90	790	1521	36,90	
		OM4A	4,00	2,98											731	620	1351	24,21	620	1351	24,21				580	1311	28,70										
4BPS9-18	18	OP4	5,00	3,73	160,0	139,0	133,0	129,0	123,0	117,0	104,0	89,0	67,0	40,0	m	731																					
		4WP	5,00	3,73											731																						
		4WP	5,50	4,1											731	555	1286	30,30	555	1286	30,30				555	1286	30,30										
		M4P7	5,50	4,1											893	790	1683	38,10	790	1683	38,10	790	1683	38,10													
4BPS9-22	22	OM4A	5,50	4,1											893																						
		OP4	5,00	3,73	200,0	170,0	165,0	159,0	152,0	147,0	132,0	111,0	84,0	50,0	m	893	675	1568	27,92	675	1568	28,01															
		4WP	5,00	3,73											893																						
		4WP	5,50	4,1											893	555	1448	31,50	555	1448	31,50				555	1448	31,50										
4BPS9-24	24	M4P7	5,50	4,1											993	790	1783	39,70	790	1783	39,70	790	1783	39,70													
		OM4A	5,50	4,1	220,0	189,0	182,0	177,0	170,0	162,0	148,0	125,0	95,0	55,0	m	993	675	1688	29,52	675	1688	29,61															
		4WP	5,50	4,1											993	555	1548	33,10	555	1548	33,10				555	1548	33,10										
		M4P7	7,50	5,59											1303	790	2093	41,60	790	2093	41,60	790	2093	41,60													
4BPS9-34	34	OM4A	7,50	5,59	308,0	263,0	255,0	246,0	236,0	225,0	200,0	167,0	122,0	69,0	m	1303	750	2053	34,65	750	2053	34,75															
		4WP	7,50	5,59											1303	675	1978	41,00	675	1978	41,00				675	1978	41,00										
		M4P7	10,00	7,49	394,0	339,0	328,0	317,0	305,0	292,0	261,0	220,0	167,0	90,0	m	1620	1689	3309	82,70	1689	3309	82,70	1689	3309	82,70												
		OM4A	10,00	7,49											1620	850	2470	44,20	850	2470	44,04																
4BPS9-43	43	OM4A																																			